

REACH IP ALARM UNIT

Self Installation instructions

Please find enclosed your Reach IP Unit and Touch 2 Pendant.

All the equipment is ready to use (see below) and will be active by following the instructions overleaf.

Supplied in the box...

Reach IP Unit



Touch 2 Pendant & Wearing Options

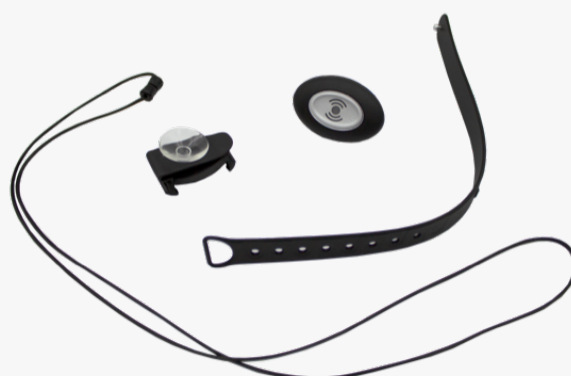

AC Adapter with UK and EU Plugs



Stand

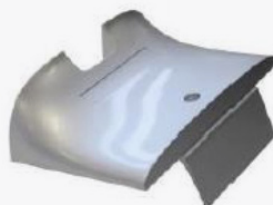

Connector Cover



Screw for
Stand/Cover



REACH IP ALARM UNIT

Self Installation instructions

Setting-up the Reach IP unit

- 1 Plug the AC Adapter Lead into the Reach IP unit **Supply** port. (Dependent upon your provider the AC Adapter and lead may already be attached to your unit).



- 2 Place the alarm close to where you will be sitting during the day and plug into an available power socket.



- 3 Switch on the alarm by holding the black power button for 1 second until all lights flash.

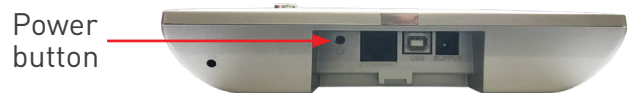

The status light will be green and then go out once the unit has a signal. This may take up to 1 minute.

- 4 Test your Touch 2 Pendant from the furthest points in your home.



Simply press the **Touch 2 Pendant** button once.

The button will **FLASH RED ((•))** for several seconds to confirm a call is being made.

The **Alarm Unit** will announce **“Calling for help - please wait”** and you will be connected to your provider who will confirm you are all operational.

Making an Alarm Call from the Reach IP Unit

Press the large red button on the front of the unit and it will announce **“Calling for help - please wait”** and the alarm call will be made.

