



The voice of technology
enabled care



Building Your TEC Knowhow

Raising awareness, knowledge and skills across staff to
bring about sustainable transformation in the adoption
of technology enabled care

‘Development is shifting from activities that are **‘done to’** learners, to resources that are **‘available to’** staff to access in their own **ways.’** - CIPD



Building Your TEC Knowhow



Door Access

Does this technology support or mitigate fire risks for Jules?

Add this item to your technology bag?

NO

YES

Note: Technologies added to the bag cannot be removed.



Fire Risk Expert - Technology selection results

Technologies		
Key Safe	House Front	✓
Smoke Detector	Lounge	✓
Not required technologies		
Activity Monitoring	Hallway	✗
Door Access	House Front	✗
Smart Bulbs	Kitchen	✗
Sensory Loss Telephone	Kitchen	✗
Smoke Detector	Individual	✗

Try again

NEXT

Creating an immersive learning environment



Advocate Level



The Advocate level is an introduction to Technology Enabled Care, demystifying the jargon and outlining how using technology can enrich a person's life to remain safe and independent at home, while offering peace of mind to family and Carers. Through a series of short courses, supported with curated content, a learner will gain an understanding of the different types of technologies and solutions available and learn about needs and risks and how some technologies can manage these.

After completing a short quiz, the learner is directed to the TSA Virtual House and learn how to explore the house and all its features. On completion the learner is awarded the Advocate digital badge.



Practitioner Level

The Practitioner level begins by categorising the 8 most common areas, or concerns, that technology can support an individual, before exploring how technology can also support family members, Carers and unpaid Carers sharing people's stories with lived experience.

As a Practitioner a learner builds their knowledge of how and where to select the right technologies or TEC Service and begin to understand the importance of a person-centred approach to choosing the right solutions. This level explores things to consider if they are installing the solutions themselves and we begin to understand more about the role of risk assessing.

When the learner enters the Virtual House in this module, through immersive learning we begin to bring to life the identifying risks, associating needs and prescribing technologies. On completion of this level, the learner is awarded the Practitioner digital badge.

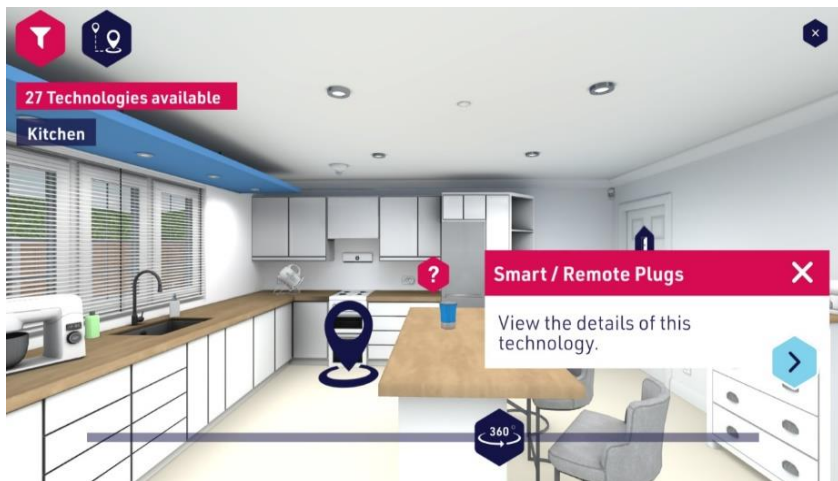



Expert Level

Building on what was been learnt in the Advocate and Practitioner levels, the Expert level takes an in-depth exploration of using technology to enhance independence and wellbeing.

As an Expert, a learner explores the role of ethics, safeguarding, valid and informed consent and the limitations and constraints that should be considered when prescribing technologies. As an Expert, a learner gains an understanding of accountability, and the importance of continuing to review the solutions a person is using to ensure they continue to meet the needs of the individual.

This level also incorporates risks and consequences, so when the learner enters the Virtual House in this module, through emotive and immersive experiences the learner is presented with a “Case Scenario” and they are asked to identify the needs and risks and prescribe solutions they feel would be beneficial in each situation seeing the impact of their decisions.

On completion of this level, the learner is awarded the Expert digital badge.

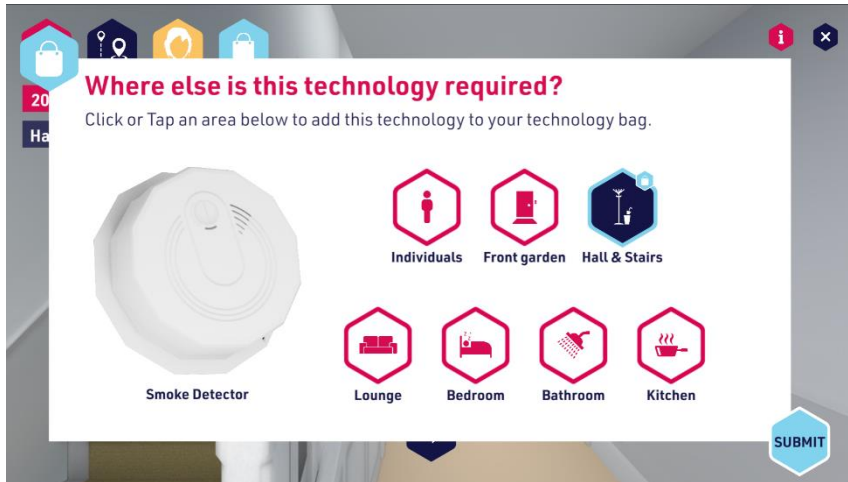

Building Your TEC Knowhow



Delivering the **best care** for our population relies on **our people** having the right **skills and knowledge** to **leverage all the digital tools** they have available.

Stacie Coburn -
Director of Performance
Cambridgeshire and Peterborough ICS.

